

## 9. TEST PROCEDURE

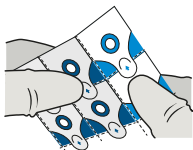

Bend the block along the perforation lines.

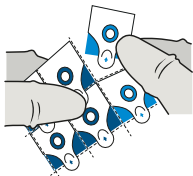

Separate one test for examination and put it on a flat surface.



Open the protective cover, but do not pull hard not to tear it off, place the biopsy specimen on the white reactive element, and not beyond.



After placing the biopsy, gently smooth the protective cover with your finger around the perimeter of the test.



Fix the cover along the cut line. Fixation is necessary to preserve the reaction products in the express test cell.

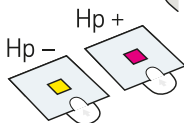

Check the result from the back of the test after **5 minutes**.